

Infinitybox™ 10 and 20-Circuit Kit Installation Guide

Table of Contents

Warnings	2
Installation Steps.....	3
STEP 1: Mounting the Cells	4
STEP 2: Running Power from the Battery	7
STEP 3: Connecting the CAN Cable	9
STEP 4: Wiring the POWERCELL Outputs	11
STEP 5: Wiring the Switches.....	14
STEP 6: Testing the System	16
Checking CAN Communication.....	16
Checking Switches.....	17
Checking the Outputs	17
Warranty Information.....	18
Contact Information.....	19

Warnings

THE INFINITYBOX SYSTEM IS AN ADVANCED ELECTRICAL POWER DISTRIBUTION MODULE FOR VEHICLES. PROPER CARE MUST BE TAKEN TO FUSE THE INPUT FEEDS TO THE SYSTEM AND THE OUTPUT FEEDS FROM THE **POWERCELLS**. IMPROPER FUSE SELECTION CAN CAUSE DAMAGE TO THE VEHICLE ELECTRICAL SYSTEM RESULTING IN FIRE.

PROPER CARE MUST BE TAKEN TO ENSURE THAT POWER IS CORRECTLY APPLIED TO THE INFINITYBOX HARDWARE. REVERSING POLARITY TO THE POWER AND GROUND FEEDS WILL CAUSE IRREPARABLE DAMAGE TO THE CELL AND WILL VOID THE WARRANTY.

THE INPUTS TO THE **MASTERCELL** ARE DESIGNED TO BE GROUND SWITCHED. APPLYING POSITIVE BATTERY POWER TO AN INPUT MAY DAMAGE THE **MASTERCELL** AND WILL VOID THE WARRANTY.

ADDING ANY ELECTRONICS MODULES TO A VEHICLE WILL INCREASE THE DEMAND ON THE BATTERY. CARE MUST BE TAKEN TO MAINTAIN A CHARGE ON THE BATTERY WHEN THE VEHICLE SITS IDLE FOR PERIODS OF TIME. THIS IS ESPECIALLY IMPORTANT WITH **GEL-CELL** AND **AGM** BATTERIES. DEPENDING ON THE TYPE OF BATTERIES AND THE TOTAL AMOUNT OF ELECTRONICS INSTALLED IN THE CAR, THIS IDLE TIME COULD RANGE FROM MONTHS DOWN TO DAYS BEFORE THE BATTERY IS DRAINED TO THE POINT WHERE YOU CANNOT START THE ENGINE. WE STRONGLY RECOMMEND INSTALLING A DISCONNECT SWITCH THAT SEPARATES THE ELECTRICAL LOADS IN THE VEHICLE FROM THE BATTERY WHEN NOT IN USE.

Installation Steps

STOP & READ CAREFULLY!

You are about to wire your car with the Infinitybox system. There is no system on the market that is going to give you the power and flexibility that you can get with Infinitybox. There are a few things you need to consider as you go through this process.

- Read the Instructions
 - We've been evolving these instructions since we started our business. We've learned from the questions that we get from customers. These lessons are summarized here. We are always adding more information to our website. Check it out at www.infinitybox.com.
- Find your Configuration Sheet
 - Every kit includes a printed copy of your configuration sheet. This is your roadmap to wiring the car. It will identify which input wires connect to your switches and which output wires connect to your loads. We have several different configurations and yours will be specific to your kit.
- Safety
 - The electrical wiring system controls everything in your car. It is what really makes it go. Fuel delivery, starting the engine, managing the ignition, keeping things cool, safety, audio and entertainment all need reliable electrical power to work correctly. Follow our instructions carefully.
- Use the Right Tools
 - Stay away from Home Depot, Crutchfield and Radio Shack when buying tools and supplies to wire your car. Give our technical support team a call if you need help getting the parts and tools to do the job correctly. Companies like Del City, Waytek Wire and Terminal Supply Company are experts in automotive wiring products.
- Ask Questions
 - Wiring is a daunting process for anyone. The worst thing that you can do as you go through the process is not ask a question, no matter how basic it may seem. We have a great team tech guys that can help with any question.
- Read the Instructions
 - Did we mention that you should read the instructions? There is also a wealth of specific wiring examples in the RESOURCES section of our website at www.infinitybox.com.

Each section of this manual will have detailed instructions on what you need to do. There will be a check list of steps that you should have completed as the part of that section. Please use this as a tool to help make you installation simple and efficient.

STEP 1: Mounting the Cells

The Infinitybox system is a modular, multiplexed wiring system. This means that there are multiple remote cells that are mounted in the car where you need them.

The MASTERCELL connects to your switches. You will mount that close to your switches. The MASTERCELL is also your main diagnostics tool for the system. You should locate it in the vehicle where you can get reasonable access to view the inSIGHT screen, remove the cover and push the buttons under the cover. You should also mount the MASTERCELL in a location where you can easily plug and unplug the harnesses for maintenance.

The POWERCELLs control your loads (headlights, cooling fans, ECU power, starter solenoid, horn and other switched accessories). In most installations, you will mount one POWERCELL in the front of the car and one POWERCELL in the rear. The POWERCELL holds the fuses that protect the wires in your harness. You need to have access to the POWERCELL to be able to change fuses if they ever were to open. You should also mount the POWERCELL in a location where you can easily plug and unplug the harnesses for maintenance.

The difference between the Infinitybox 10 and 20 Circuit Kits is the number of POWERCELLs included in the kit. Each POWERCELL has 10 outputs. The 10-Circuit Kit comes with one POWERCELL and the 20-Circuit Kit comes with 2 POWERCELLs.

The POWERCELLs are designed to be mounted under the hood. They were designed and tested to survive the extreme temperatures, chemicals and vibrations found in the engine compartment. The one warning with mounting POWERCELLs under the hood is to keep them clear of exhaust headers and ignition coil wires.

The mounting locations are identical for all the Infinitybox cells. This includes the MASTERCELL, POWERCELL and inMOTION Cell. The mounting points were designed for a 1/4" stud, ideally a 5/8" long shoulder screw. You can use any mounting hardware that you choose. Take care not to crush the mounting points by over-tightening the hardware.

The POWERCELLs carry all the electrical current in your system. They are designed to carry up to 125-amps continuously per cell. In most applications, you can mount them anywhere in the vehicle in any orientation. If your continuous current draw through a POWERCELL will exceed 80-amps, it is recommended that the POWERCELL be in an open area with free air flow. The POWERCELL should be mounted with the fins on the heat sink oriented vertically. Contact our technical support group with questions on current usage and mounting.

NOTE: When installing your Infinitybox system in your car, it is important that you keep the clear, protective covers on the cells. This is to keep dirt, metal chips, welding splatter and other debris from entering the cells. Improper protection of the cells while installing them will cause damage to the electronics inside the cell and void the warranty.

ALSO NOTE: The MASTERCELLs and POWERCELLs are only sealed when all the ports are plugged. There are dummy plugs to seal the unused CAN ports and power input powers. If you do not install all the plugs in the system, you run the risk of water, moisture, dirt and debris entering the cells. This could damage the cells and will void the warranty.

The address on the POWERCELL must be set to match the address defined in your configuration sheet. If you have a 10-Circuit Kit, your POWERCELL will be set at address 1. If you have a 20-Circuit Kit, the front POWERCELL address must be set as 1. The rear POWERCELL must be set as 2. If you have additional POWERCELLs or inMOTION cells in your system, your configuration sheet will identify the address numbers for those cells. Check your configuration sheet and follow the steps below to set the address jumpers. This picture shows where the address headers are located under the POWERCELL cover.

LOCATING THE ADDRESS

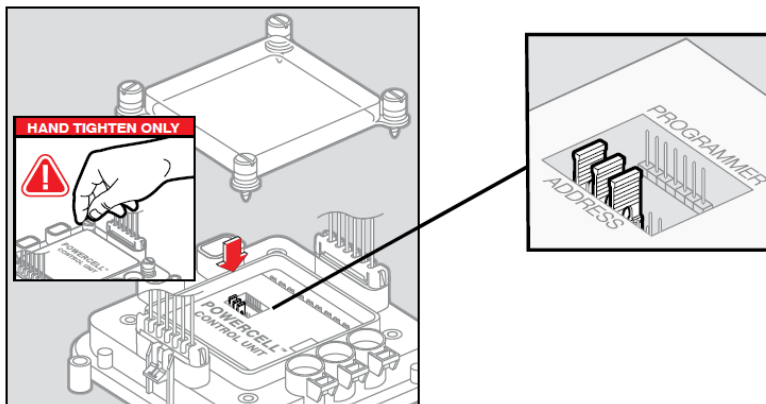

This picture shows how to properly orient the jumpers on the headers to set the cell address.

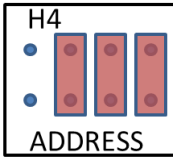

CELL A1

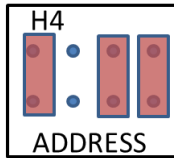

CELL A2

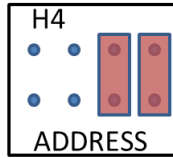

CELL A3

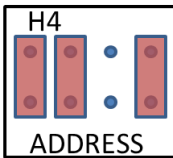

CELL A4

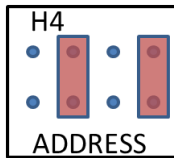

CELL A5

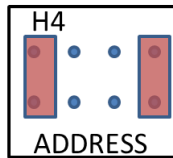

CELL A6

Check List for Step 1- Mounting the Cells

- ☐ Did you consider the best locations for your cells considering troubleshooting, replacing fuses and other maintenance?
- ☐ Are your cells mounted clear from high-voltage ignition coil wires and radiated heat from exhaust headers?
- ☐ Do you have your front & rear POWERCELLs set at the correct address?

STEP 2: Running Power from the Battery

Each POWERCELL needs to connect directly to the positive terminal on your battery. This is where the POWERCELL gets the power needed to control the switched loads in the car. Your kit includes two 8-gauge red power feeds per POWERCELL. The black connectors on the end of these cables connect to the round power input ports on the POWERCELLS.

Also included in your kit is a block of 60-amp fuses. There are two of these Mega fuses per POWERCELL. Each of these fuses is designed to properly protect a length of 8-gauge wire. If one of those 8-gauge wires were to get connected to ground, the fuse is designed to be the weakest link in the chain. The fuse will open before the 8-gauge wire can get hot and cause damage. You want to mount this fuse holder as close to the battery as possible. The goal is to minimize the length of unprotected wire in the electrical system.

Follow these steps to properly connect your battery to the POWERCELLs in your kit.

Step 1: Mount the 4-position fuse block

Step 2: Connect the positive terminal of the battery to the fuse holder. Use the included length of 4-AWG cable and the two 4-AWG ring terminals to make this connection. We recommend protecting the exposed metal parts of the ring terminals with heat-shrink tubing to reduce the chance of accidental connections to the chassis.

Step 3: Cut the red 8-gauge power feed wires to length and crimp on the included 5/16" 8-gauge ring terminals. We recommend protecting the exposed metal parts of the ring terminals with heat-shrink tubing to reduce the chance of accidental connections to the chassis.

Step 4: Connect the POWERCELL power feeds to the fuse holder.

Step 5- Plug the power feeds into the circular input connectors on the POWERCELLS.

Step 6: Insert dummy plugs into the unused power input ports on both POWERCELLS.

NOTE: The POWERCELLs must have a separate battery power feed from the starter cable. Do not connect a POWERCELL to the starter side of the starter cable. The POWERCELLs in the vehicle must get powered directly from the battery.

NOTE: A battery disconnect is strongly recommended with the Infinitybox system. You are adding a very sophisticated electrical system to your vehicle. We do what we can to minimize the amount of steady-state draw but there will always be a small drain on the battery when the vehicle is sitting idle. A battery disconnect or our inRESERVE Active Battery Management System is strongly recommended to disconnect the battery when the vehicle is not being used.

Check List for Step 2- Running Power from the Battery

- ☐ Are both of your POWERCELLs powered from the same block of Megafuses?
- ☐ Do you have your Megafuse holder connected directly to the battery on the shortest run of 4-AWG wire as possible?
- ☐ Did you tighten the bolted connections on the Megafuse holder?
- ☐ Did you close the covers on the Megafuse holders?

STEP 3: Connecting the CAN Cable

The CAN cable connects the MASTERCELL to the POWERCELLs in your system. It passes commands between the different cells to turn things on and off. CAN stands for Controller Area Network. We are using the same CAN protocols as commercial truck and heavy-duty vehicle manufacturers.

There is one CAN port on the MASTERCELL and two CAN ports on each of the POWERCELLs. The two ports on the POWERCELLs are identical so you can connect the CAN cables into either port.

If you have a 10-Circuit Kit, you have a 2-way CAN cable. The cable has a CAN connector on each end. You plug one end of this cable into the CAN port on the MASTERCELL. The second end of the cable plugs into one of the open CAN ports on your POWERCELL.

The CAN cable that comes with your 20-Circuit Harness Kit has a plug on either end and a plug in the middle. You can plug this cable into your cells in any way that is convenient for your vehicle.

The CAN plugs are keyed so that they can only plug into the MASTERCELL or POWERCELL one way. The locking tab on the connector should face to the outside of the cell. Do not force these plugs into the CAN ports on the cells. If it is difficult to insert them, check the pins in the port to make sure that they are straight.

You may shorten or lengthen your CAN cable as required for your specific vehicle. There is no minimum length for a CAN cable. Contact our technical support team if you are going to lengthen your CAN cable beyond 20 feet in length. We use 22-gauge TXL wire in these cables. You can source this wire yourself or give our team a call and we can help you get this wire. You can also contact our team about having us build custom cable lengths for your specific project.

Once you have your CAN cables routed and plugged into your cells, install the included terminating resistor plug into the open CAN port on the POWERCELL that is furthest away from the MASTERCELL on the length of your CAN cable. The terminating resistor is the plug with the letter "R" marked on the top. Plug the CAN dummy plug into the open CAN port on the other POWERCELL to keep the cell sealed.

Older versions of the 3-Way CAN cable included with the 20-Circuit Kit will have a red power wire and a black ground wire in both legs of the cable. If you have red & black wires in both legs of the 3-Way CAN cable, you need to cut one of these pairs. Make sure that these wires are safely taped off, so they do not come into contact with anything. If you only have the red & black wires in one leg of the 3-Way CAN cable, you can skip this step.

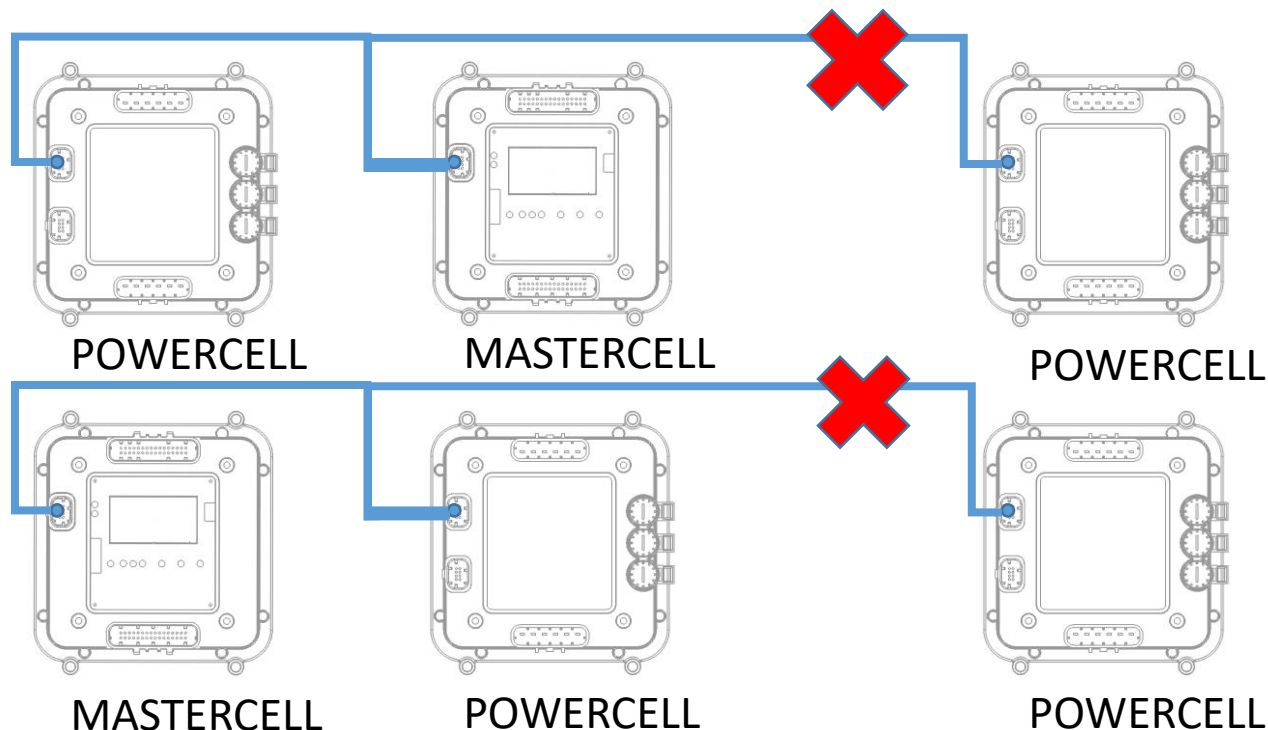

X = Cut red and black wires in this leg

If you have your MASTERCELL on one end of the cable with a POWERCELL in the middle and one POWERCELL at the other end, you must cut the red and black wires between the two POWERCELLs. If you have the MASTERCELL on the middle connector of the cable with the two POWERCELLs on the ends, you need to cut the red and black wires between the MASTERCELL and the POWERCELL on the long leg of the CAN cable. The following figure shows where to cut the red and black wires. Please note that you only need to cut these wires if you have a 3-Way CAN cable and a 20-Circuit Kit with two POWERCELLs. You only need to do this step if you have red & black wires in both legs of the 3-Way CAN harness.

NOTE: Keep the CAN cables away from any high-voltage ignition coil wires.

Check List for Step 3- Connecting the CAN cables

- ☐ Did you cut the red & black wires per the diagram above if you have a 20-Circuit Kit and you have red & black wires in both legs of the 3-Way CAN cable?
- ☐ Is your CAN cable routed away from high-voltage ignition coil wires?
- ☐ Did you install the CAN dummy plug?
- ☐ Did you install the CAN Terminator Resistor?

STEP 4: Wiring the POWERCELL Outputs

Consider each POWERCELL as a fuse and relay box. It gets power from the battery and commands from the MASTERCELL. It supplies battery power to a load in your vehicle when you turn on a switch connected to the MASTERCELL.

There are two output harnesses for each POWERCELL that are included with your kit. This picture shows which output harness connects to the output ports on the POWERCELL. These harnesses are interchangeable so make sure that you are connecting them into the proper ports on the POWERCELL.

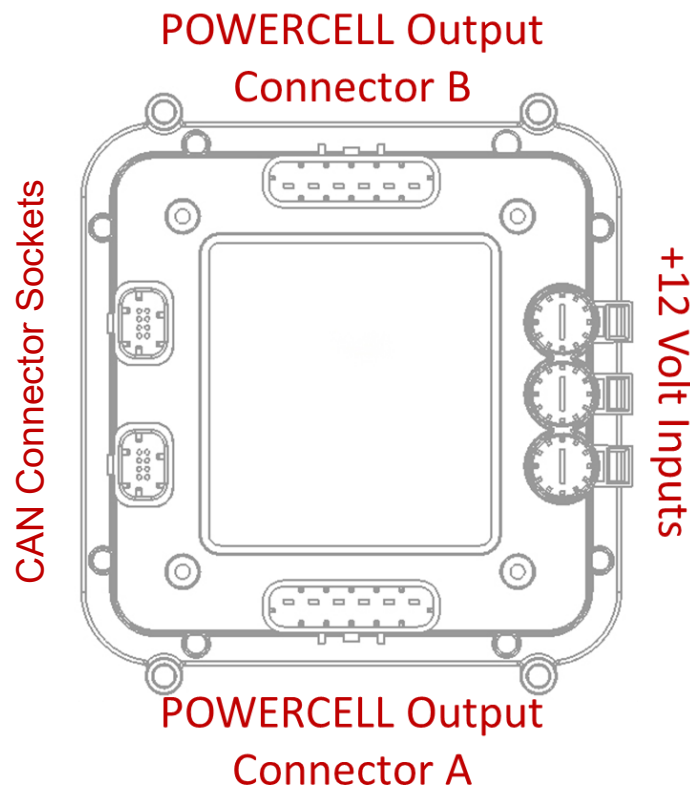

These tables summarize the wire colors for the A & B Output Harnesses.

POWERCELL A Connector Pinouts

Cavity Identification	Function	Reference Wire Color
A	Ground	Black
B	Output 10	Tan
C	Output 9	Orange
D	Output 8*	Green
E	Output 7*	Blue
F	Output 6*	Yellow

POWERCELL B Connector Pinouts

Cavity Identification	Function	Reference Wire Color
A	Ground	Black
B	Output 1*	Brown
C	Output 2*	Violet
D	Output 3*	Light-Green
E	Output 4*	Light-Blue
F	Output 5*	White

Each POWERCELL output harness has a black wire. These wires must be connected to ground. This should be done locally at the POWERCELL. Make sure that you have a good electrical connection to the chassis. This means you must have a metal to metal connection to ground. Take care to remove all dirt, paint, grease, paint or powder coating to get to bare metal for this connection. We do not recommend using the screws used for mounting the POWERCELL as the point for the ground connection. Use a separate connection directly to the chassis.

The configuration sheet is your key to wiring your vehicle. It shows you the MASTERCELL input wires that connect to your switches and the POWERCELL output wires that connect to your loads. These are all done by wire color. Each configuration sheet is specific to your kit. If you have questions about the configuration sheet or have lost it, give our technical support team a call.

All the switched loads in your car will connect to a POWERCELL output. When the output is on, the POWERCELL supplies battery voltage on the output wire. You connect this wire to your load then ground your load to the chassis. See the Resources section of our website for specific wiring diagrams for lights, turn signals, fans and other electrical loads.

There is a fuse holder for each output wire on the POWERCELL located under the clear cover. This fuse is designed to protect the wire in case it gets accidentally shorted to ground. The side of the fuse depends on the smallest size of wire connected to the POWERCELL output, not necessarily what is connected to the output. The following table gives recommended fuse sizes for wire gauges.

Wire Gauge (AWG)	Recommended Fuse Size for TXL Insulation
20	7.5
18	10
16	15
14	25

The wires gauge used in the standard POWERCELL output harnesses is 14-AWG.

Each POWERCELL output wire can carry up to 25-amps. This means that you can have multiple loads connected to a single output. For example, you can use the Ignition output on your system to control multiple loads. This includes power to your ECU or coil, your gauge power and the power to your stereo. When the ignition is turned on, all these functions will turn on.

Check List for STEP 4: Wiring the POWERCELL Outputs

- ☐ Do you have the output harnesses plugged into the correct output connector ports?
- ☐ Do you have the black wires from each output connector connected to a good ground on the chassis?
- ☐ Did you follow the wire colors on the configuration sheet that came with your kit?
- ☐ Did you install fuses in the POWERCELL for each load?

STEP 5: Wiring the Switches

Wiring the switches in your car to your MASTERCELL inputs is the easiest part of the process. Every function in your car has a MASTERCELL input assigned to it. See the configuration sheet that came with your kit for these details.

To turn on an input, the MASTERCELL input needs to be connected to ground. The MASTERCELL input will connect to one side of the switch. You will then ground the other side of the switch. When you turn the switch on, the switch closes which connects the MASTERCELL input to ground. This picture shows a simple example of how to connect a switch to a MASTERCELL input.

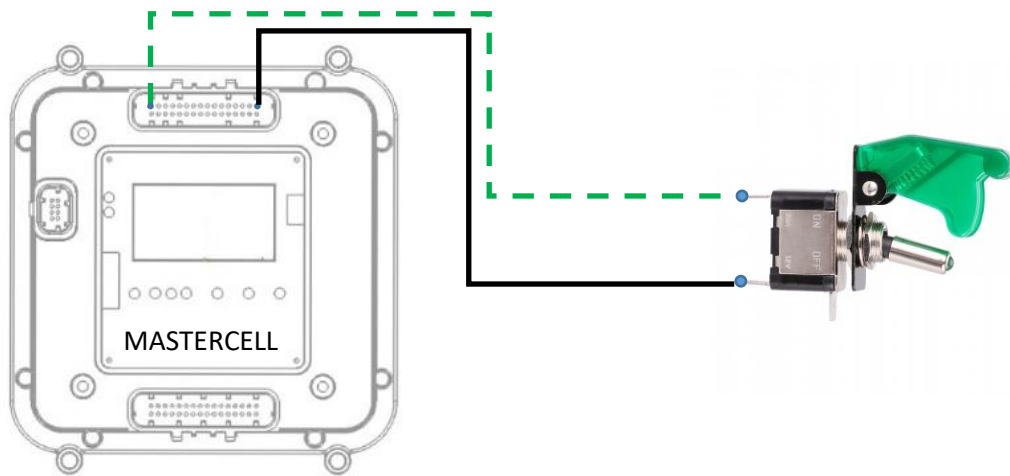

There are two input connector ports on the MASTERCELL. The A connector is located above the screen. The B is located below the screen. Your configuration sheet will detail which connector has the input wires that you will need for your project. In most cases, the B connector will not be used. Your kit will include a dummy plug to seal this unused port.

The MASTERCELL input harnesses include several black wires that can be used as the ground for your switches. Alternately, you can ground your switches to the chassis ground in your car, just make sure that you have solid, metal-to-metal connection.

NOTE: The MASTERCELL input wires are intended to be connected to ground to turn on a circuit. Do not apply positive battery voltage to the input wires. Connecting MASTERCELL inputs to battery voltage will damage the inputs and void your warranty.

No matter how complicated the switch is, there is almost always a set of contacts that will close together in the on position that can be used to trigger a MASTERCELL input. You can usually figure this out with a few minutes spent with a continuity tester or a multi-meter set to measure resistance. We also have a large catalogue of switch examples on our website. Look for the Resources section at www.infinitybox.com.

Check List for STEP 5: Wiring the Switches

- ☐ Did you follow the wire colors on the configuration sheet that came with your kit?
- ☐ Did you make sure that your switches are wired so that no battery voltage can be applied to the input?
- ☐ Do you have a good connection for the ground side of your switches either using one of the black wires in the MASTERCELL harness or a metal-to-metal connection to the chassis?

STEP 6: Testing the System

Once the hardware is properly set up, connect +12 volts through the input harnesses to the POWERCELLs. After 3 seconds, the system will be running and ready to test.

There are three steps that you should follow when you start to test your system: Check CAN communication between the cells, check the switches and check the outputs. The following section will walk you through these steps. There is a much more comprehensive diagnostic and troubleshooting guide available in the Resources section of our website.

Checking CAN Communication

The MASTERCELL sends commands to the POWERCELLs installed connected in the system. Every second, the MASTERCELL sends a command to verify that all the cells are connected and healthy. We call this a heartbeat. When the system is up and running correctly, you will see a heartbeat indicator on all the cells. On the MASTERCELL, this is the COM light under the screen. It is a blue light and will blink approximately once per second. On the POWERCELLs, there is a similar blue light towards the center of the cell under the clear cover. This will blink approximately once per second when it is operating correctly.

There are indicators on the MASTERCELL for CAN Hi and CAN Lo. These indicate communication between the cells. They are red and green lights that will flash randomly. This is absolutely normal. There are corresponding CAN Hi and CAN Lo lights under one of the corners under the clear cover on the POWERCELL. They will flash randomly like the indicators on the MASTERCELL. We use these lights for advanced diagnostics. The vast majority of our customers will never need to worry about these lights.

If the blue heartbeat indicators on the MASTERCELL or POWERCELLs do not flash, that means that the cell is getting power from the battery but is not communicating with the other connected cells. Check the CAN cables and the connection to the MASTERCELL.

You can confirm that all the cells are communicating by pressing the “HOME” button under the MASTERCELL screen. This will bring up a list of all the cells connected to the MASTERCELL. The first line will read A0. That is the MASTERCELL. The front POWERCELL will be listed as A1 and the rear POWERCELL is listed as A2. If you see these three lines, your system is communicating correctly.

Checking Switches

The inSIGHT screen on the MASTERCELL gives you detail on how the system is working. You can use this to verify that the switches are connected correctly. Press and hold the “SCROLL UP” and “SELECT” buttons under the MASTERCELL screen. You will get a message that says “inSIGHT will display input changes from ANY source”. This means that the MASTERCELL is in its messaging mode. Any time you turn on a switch, the MASTERCELL will display that on the screen. You can check each switch and compare it to your configuration sheet to make sure that it is wired correctly.

Checking the Outputs

Just like the MASTERCELL, the POWERCELLs have built in diagnostic tools to help check the system. There is a white LED (light emitting diode) next to each fuse under the clear cover of the POWERCELL. This white light can be either off, on bright or on dimly. The state of the lights can tell you exactly what is going on with your outputs.

If the white light is off, that means that the POWERCELL output is off and you have a good connection through the load to ground. If the white light is glowing dimly, that means that you do not have a good connection between your POWERCELL output and ground. It could mean that you have a broken wire, a blown light bulb or an open fuse. Check the wiring, the fuse and the load.

If the light is bright, that means that the POWERCELL output is on. You can turn your switches on and off and verify that the LED for that specific output is going bright when the switch is on. Use your configuration sheet to verify that the correct output numbers are tuning on with your switch.

If you have diagnostic or troubleshooting questions, download the Infinitybox Diagnostic and Troubleshooting Guide from the Resources section at www.infinitybox.com.

Warranty Information

Infinitybox, LLC ("Infinitybox") warrants against any defects in materials and workmanship to the Product's INFINITYBOX™ modules, wiring harnesses and accessory modules for a period of one (1) year from the first date of purchase. Subject to the terms of this warranty described below, Infinitybox will replace any such defective Product that is returned to Infinitybox within the one (1) year period from initial purchase. Replacement of any defective part or Product will not extend the applicable warranty period.

The warranty does not apply to: (i) any Product that is not installed in compliance with the applicable Product documentation; (ii) any defect in, or failure of, the Product resulting from an accident, shock, negligence, water immersion or misuse; (iii) any Product that has been modified, adjusted, repaired, or disassembled by any party other than Infinitybox; or (iv) any defect other than in materials and workmanship.

This warranty covers only the original purchaser of Product purchased from an Infinitybox authorized dealer in the United States. In order to receive warranty service, purchaser must provide Infinitybox with a copy of the receipt stating the dealer name, product purchased and date of purchase. Products found to be defective during the warranty period will be replaced (with a product deemed to be equivalent or better) at the discretion of Infinitybox.

Infinitybox's sole liability for any defective Product is limited solely to the replacement of Product pursuant to this warranty. Infinitybox reserves the right to replace any repairable parts with new or refurbished parts.

INFINITYBOX DISCLAIMS ALL OTHER WARRANTIES, WHETHER EXPRESS, IMPLIED OR STATUTORY, SUCH AS WARRANTIES OF MERCHANTABILITY AND FITNESS FOR PURPOSE. IN NO EVENT SHALL INFINITYBOX BE LIABLE FOR ANY PUNITIVE, INDIRECT, INCIDENTAL OR CONSEQUENTIAL DAMAGES, INCLUDING WITHOUT LIMITATION, LIABILITY FOR LOSS OF USE, LOSS OF PROFITS, LOSS OF PRODUCT OR BUSINESS INTERRUPTION HOWEVER THE SAME MAY BE CAUSED, INCLUDING NEGLIGENCE.



Contact Information

INFINITYBOX, LLC
6460 West Cortland Street
Chicago, Illinois 60707
www.infinitybox.com

The INFINITYBOX™ Intelligent Multiplex System is a product of
Infinitybox, LLC
599 North Edgewood Avenue
Wood Dale, Illinois 60191
(847) 232-1991
sales@infinitybox.com
www.infinitybox.com